

THE LODGE AT SEA ISLAND

FLOOR PLANS

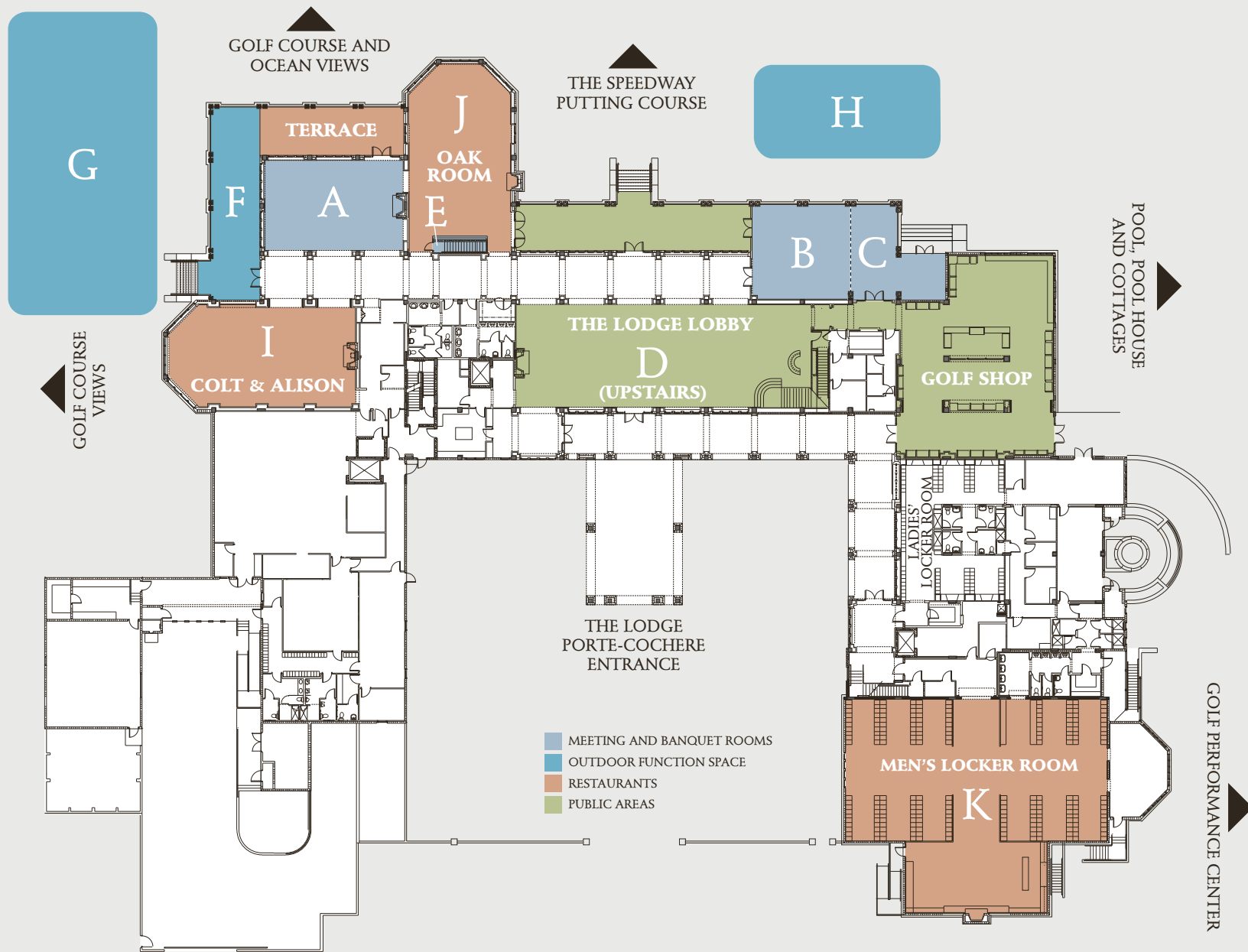

THE LODGE AT SEA ISLAND ROOM CAPACITIES

■ Meeting and Banquet Rooms
 ■ Outdoor Function Space
 ■ Restaurants
 ■ Public Areas

| LOCATION | CONFERENCE | U-SHAPE | HOLLOW | CLASSROOM | THEATER | RECEPTION | BANQUET | DIMENSIONS | SQ. FT. | CEILING HT. |
|-----------------------------------|------------|------------------------|--------|-----------|---------|-----------|---------|------------|---------|-------------|
| Meeting and Banquet Rooms— | | | | | | | | | | |
| A Terrace Room | 30 | 34 | 40 | 84 | 140 | 100 | 90 | 48' x 30' | 1,440 | 13' |
| B Trophy Room I | 24 | 18 | 28 | 40 | 115 | 80 | 64 | 30' x 30' | 900 | 12' |
| C Trophy Room II | 18 | 15 | 18 | 20 | 42 | 50 | 30 | 15' x 30' | 450 | 10' |
| Trophy Room (I & II) | 30 | 26 | 32 | 60 | 156 | 130 | 72 | 45' x 30' | 1,350 | - |
| D Parlor | 14 | - | - | - | 30 | 25 | - | 15' x 20' | 300 | 9' |
| E Lodge Wine Cellar | 20 | Permanent Dining Table | | | | 30 | 20 | 32' x 13' | 416 | 10' |
| Pool House | - | - | - | - | - | - | 40 | 22' x 39' | 835 | 15' |
| Outdoor Function Space— | | | | | | | | | | |
| F Terrace Room Veranda (Screened) | - | - | - | - | - | 60 | 40 | - | 900 | - |
| G Terrace Room Lawn | - | - | - | - | - | 200 | - | - | 5,760 | - |
| H Trophy Room Lawn | - | - | - | - | - | 130 | - | - | 1,800 | - |
| Pool Deck | - | - | - | - | - | 100 | - | - | 1,800 | - |
| Restaurants— | | | | | | | | | | |
| I Colt & Alison | - | - | - | - | - | - | 110 | 62' x 29' | 1,789 | 13' |
| J Oak Room | - | - | - | - | - | 90 | 60 | 35' x 50' | 1,750 | 13' |
| K Men's Locker Room | - | - | - | - | - | 120 | 50 | 51' x 80' | 4,080 | 10' |



■ POOL AND POOL HOUSE
■ TROPHY ROOM

■ POOL HOUSE
■ TERRACE ROOM

■ COLT & ALISON
■ LODGE WINE CELLAR